

WINTER
2020

CONSTRUCTING NEWS



LCM
LOUISIANA
CHILDREN'S
MUSEUM

CARE

PLAY

PLAY TIME!

Let the fun begin at the new
Louisiana Children's Museum



rac.com





The Louisiana Children's Museum at City Park hosts both indoor and outdoor exhibits on literacy, health and wellness, environmental education and arts and culture. The 56,000 sf, LEED Silver museum sits beautifully on less than one acre, cantilevered over a lagoon and consists of two, 2-story buildings joined by a fritted glass and steel connector. Both buildings are constructed of a steel and metal framed structure with a fiber cement panel and glass curtainwall exterior skin. The south wing contains a literacy center, parent / teacher resource center, book and toy store, administrative areas and a 165-seat full-service café named Acorn operated by Dickie Brennan & Co. The north wing houses two floors of indoor exhibit galleries that include re-imagined beloved exhibits – the grocery store and bubble studio – and a 100-foot-long Mighty Mississippi River exhibit which tells the story of the journey of the River from Lake Itasca, Minnesota, all the way to the Port of New Orleans and the Gulf of Mexico. Outdoors, the park like setting consists of pathways, a pedestrian bridge, decks, sensory and edible gardens, a newly restored wetland area and a floating classroom.



COMPLETED PROJECT

Louisiana Children's Museum
At City Park // New Orleans, Louisiana

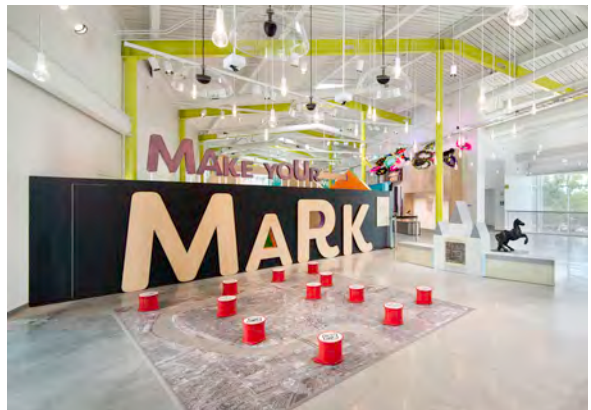

On Site

LOUISIANA CHILDREN'S MUSEUM CONTRACTOR DAY



Louisiana Children's Museum hosted Contractor Day on Aug. 18 before opening to the public on Aug. 31, 2019. Museum CEO Julia Bland states, "The new location will allow us to better meet the needs of the community as well as improve geographic access and connect children to nature in a way we haven't been able to before. We are confident the new LCM will provide even more resources to every child – and parent – who walks through our doors."

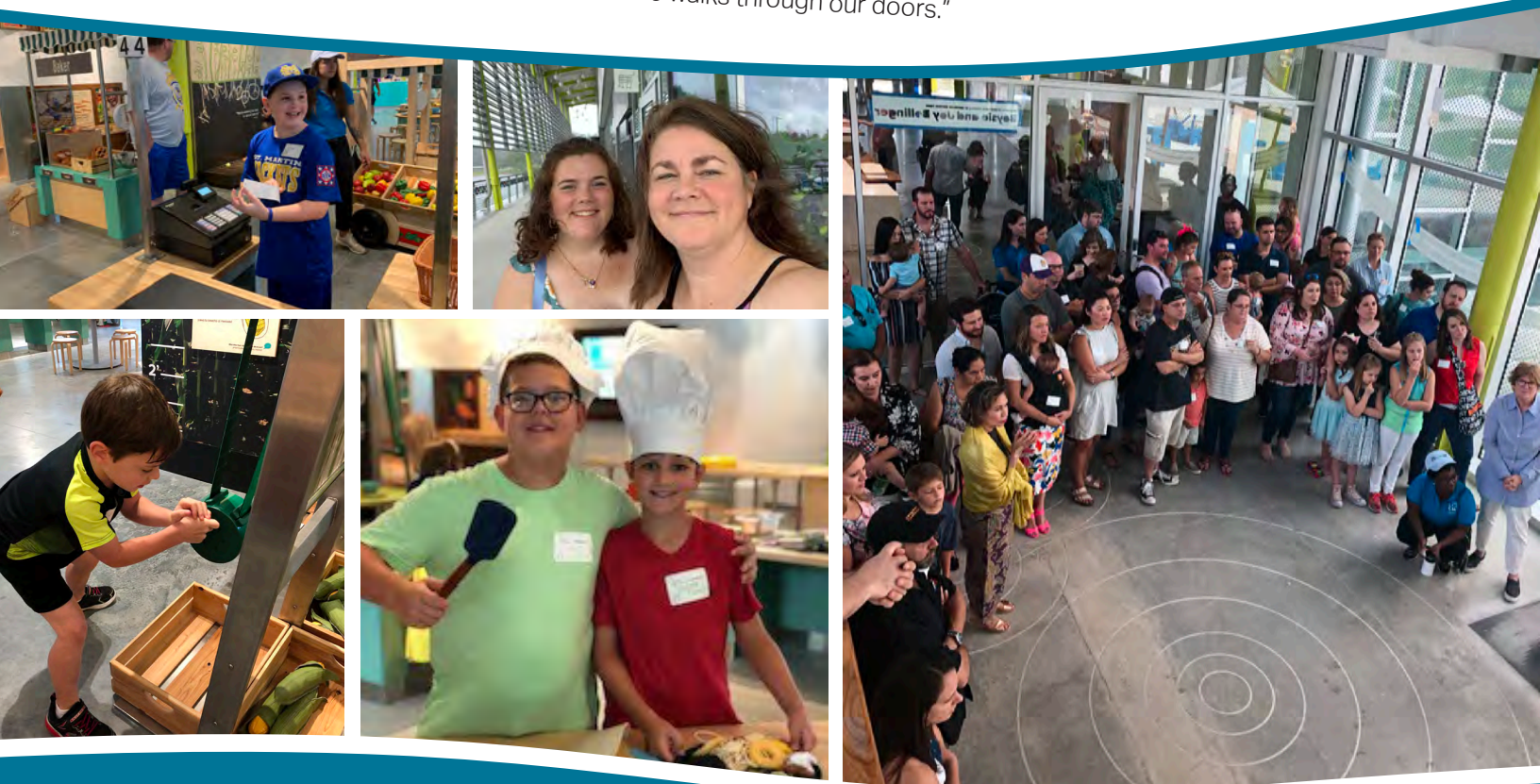

R

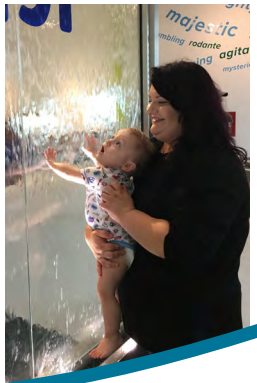

COMPLETED PROJECT

University of Mississippi Student Union Addition & Renovation // Oxford, Mississippi



Complex phased renovation and new construction. First phase included the construction of a temporary loading dock and temporary walls for pedestrian access routes. Phase 2 was the new construction of a four-story cast-in-place, 94,000 sf concrete building addition to the existing Student Union which remained occupied during construction. The new addition contains enhanced dining areas for students and a food court for five well-known food vendors, kitchens, a transit hub as well as a large ballroom. Phase 3 consisted of the complete interior and exterior demolition and renovation of the existing 3-story, 100,000 sf Union. The renovated portion contains a Barnes and Noble Book Store and Coffee Shop, a Credit Union, new Council Room, large student lounge and lobby areas, and offices and administrative areas for the Dean of Students and staff.



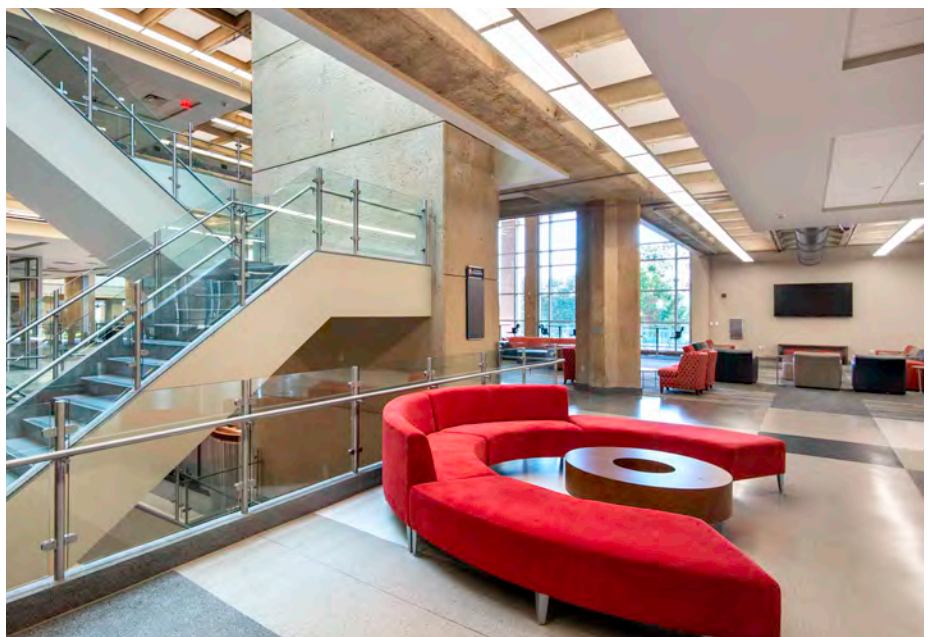
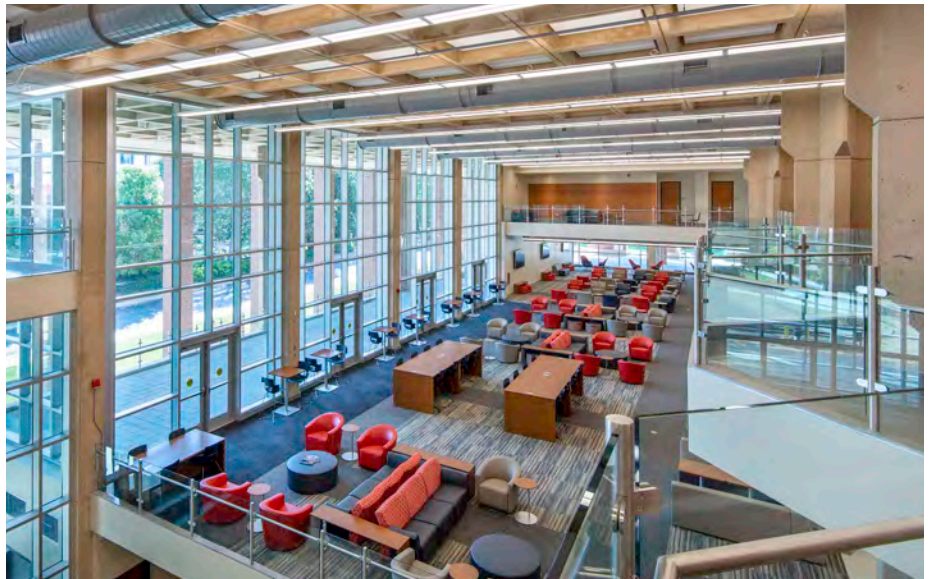

Project Progress

A GRAND OPENING



The Ole Miss Student Union on the campus of the University of Mississippi, which recently underwent major renovation, was dedicated during a grand opening ceremony in Oxford, Miss. on Aug. 29, 2019. Students got a first look at the new Student Union when it opened at the end of the 2019 spring semester, but the August ceremony officially marked the beginning of a new era.

“This fantastic renovation and expansion has been a number of years in the making, but the results show it was clearly worth the wait,” said Ole Miss interim chancellor Larry Sparks during the ceremony.

Following the ribbon-cutting ceremony, a time capsule was filled with items and placed into a wall of the Student Union. Items included an edition of *The Daily Mississippian*, the student-run newspaper, a copy of the 2019 Ole Miss yearbook, change from 2019 as well as a copy of a program from the original grand opening ceremony for the Student Union in 1978.

COMPLETED PROJECT

**World War II Museum
Hall of Democracy // New Orleans, Louisiana**

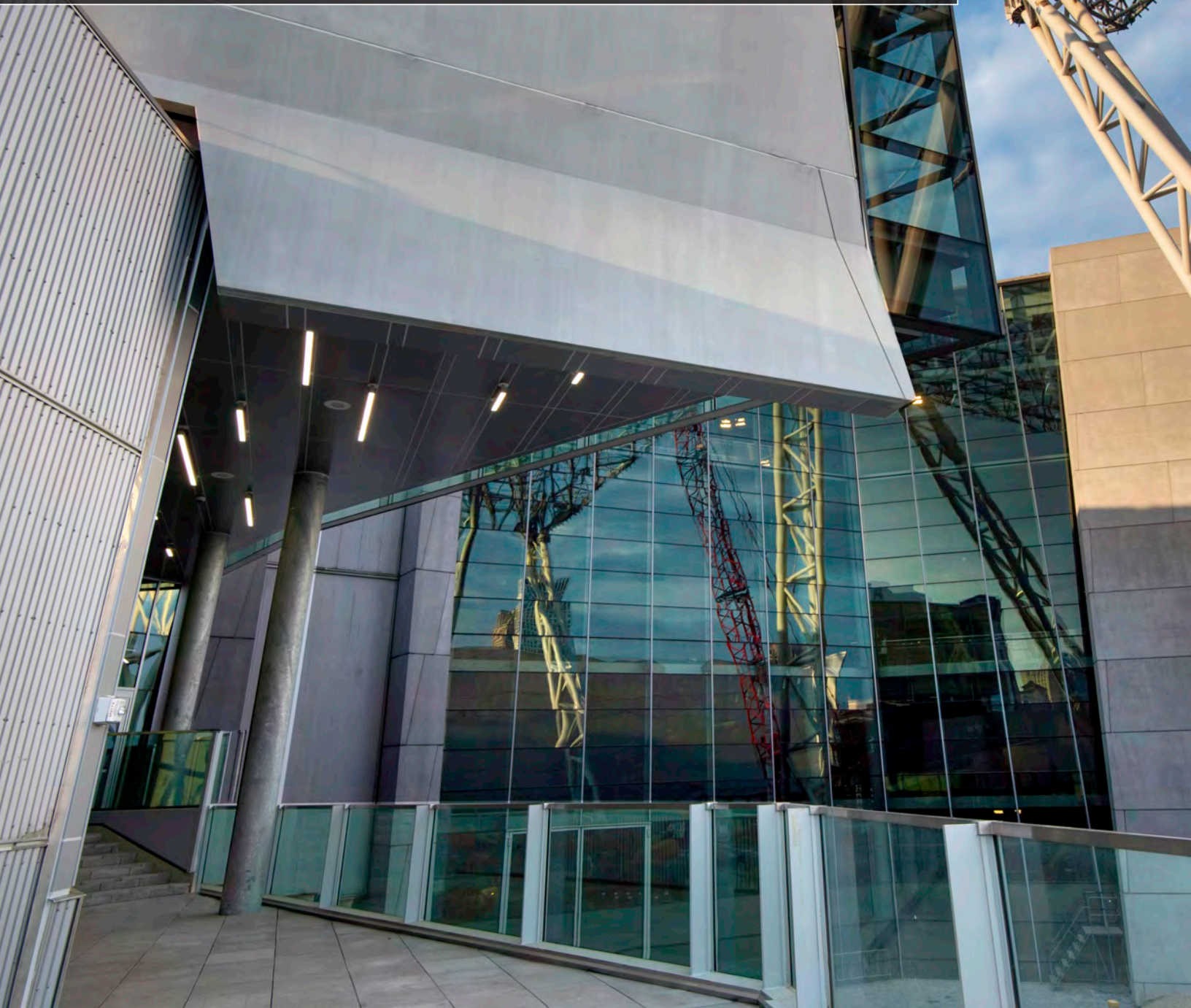

The World War II Museum Hall of Democracy is located in the heart of the World War II Museum campus and is the preeminent gateway for education, outreach, publishing, research and new media activities at the Museum. Its goal is to make WWII history and the Museum's extensive collection of oral histories, photographs, artifacts, and archives more accessible to the public through new online and learning initiatives. The pavilion will house a special exhibits gallery; a WWII Media and Education Center with production studios and broadcast capabilities for the editing, production and dissemination of the Museum's digital assets and programs; the Institute for the Study of War and Democracy; and a stunning library that will support research and public engagement.

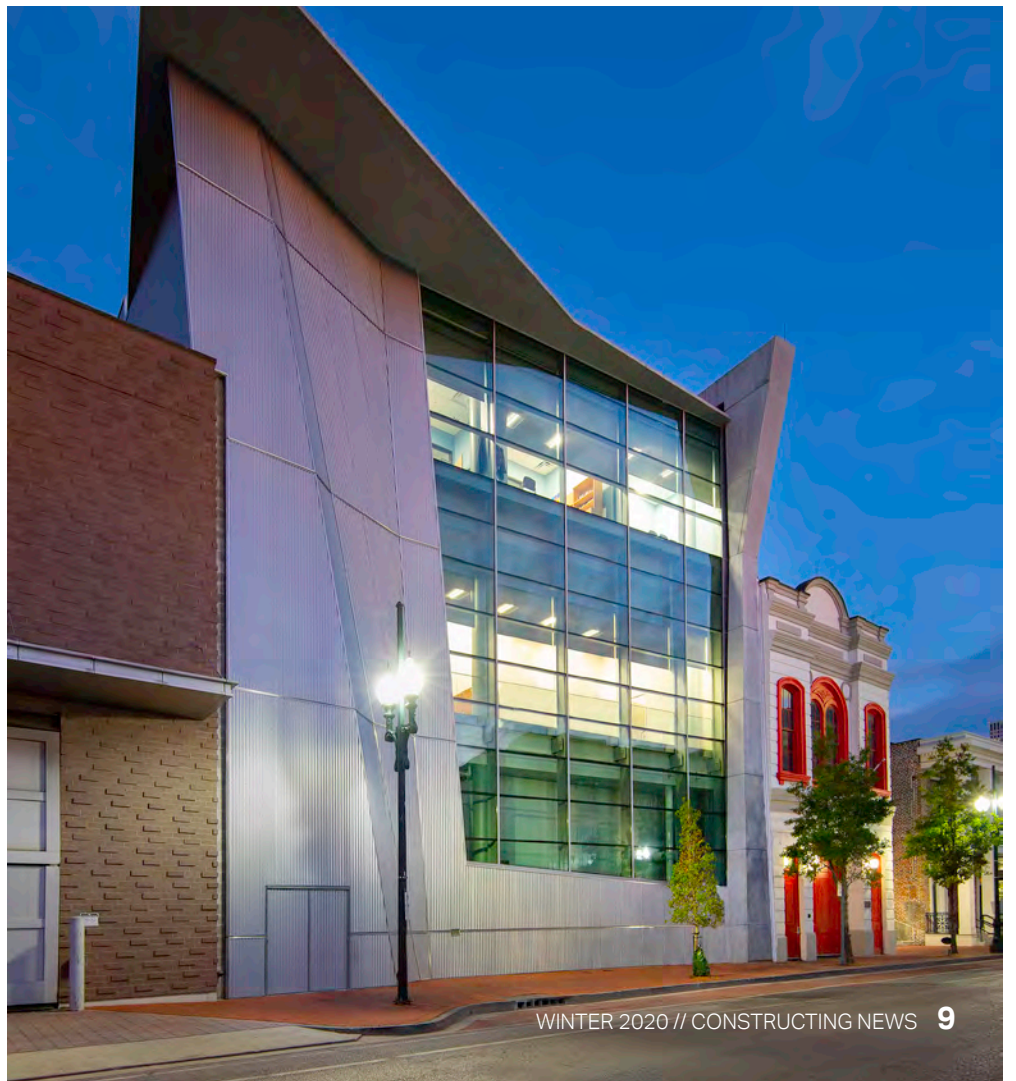
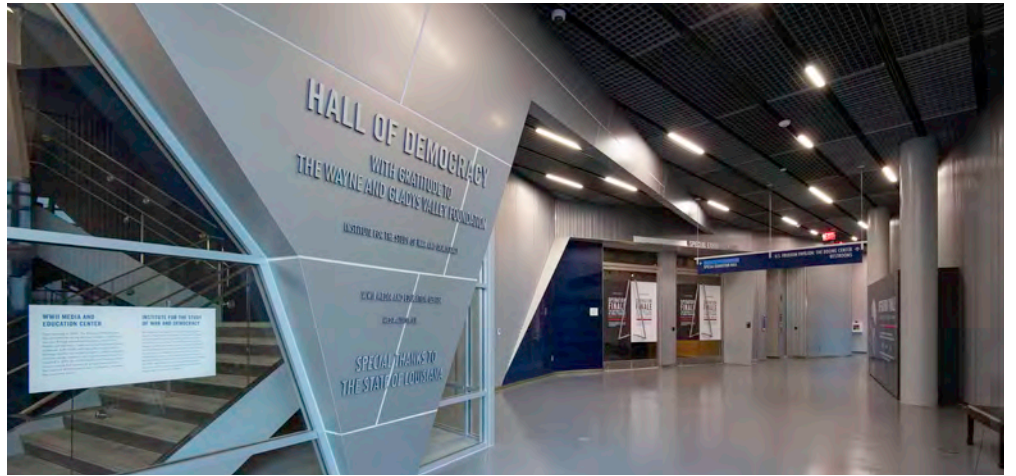



SAFE + SOUND WEEK

>>> AUG. 12-18

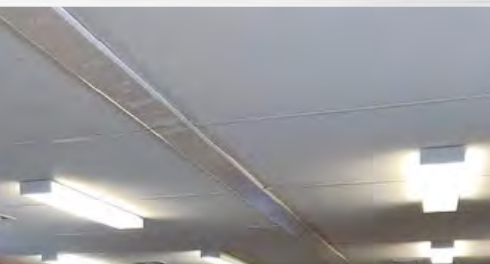

Roy Anderson Corp is proud to be 1 out of 16 companies in Mississippi to participate in Safe + Sound Week 2019. RAC was recognized for our safety successes and received the Safe + Sound Week challenge coin for 2019.



RAC CORPORATE OFFICE, pictured top left

CPR Training at our corporate office was administered by Safety Coordinator Keith Mazatos.

TOYOTA VISITOR CENTER, pictured bottom left

Worker participation is a core element of our program at RAC. Appreciation was expressed to all of our crews for safety performance so far at the Toyota Visitor Center job site in Blue Springs, Miss.



CHARLESTON INTERNATIONAL AIRPORT PARKING GARAGE, pictured top right

Safety is a top priority at RAC. The Charleston Parking Garage team conducts a site-wide safety meeting every Wednesday morning before work commences. Pictured is Site Safety Coordinator, R.D. Sutherlin, discussing the importance of daily equipment checks, special awareness on a busy job site and continual housekeeping. Baker Concrete provided a translator to relay all information to our multilingual workers. This helps ensure a safe work place for everyone.



SOUTHLAND GAMING & RACING RESORT, pictured bottom right

Safety Luncheon with special giveaways at the Southland Gaming Casino job site in West Memphis, Ark.



On Top

INDUSTRY AWARDS

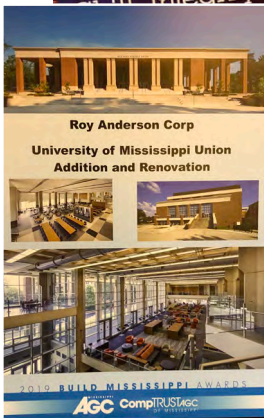

Roy Anderson Corp received recognition at the 2019 AGC Build Mississippi Awards. The event was held on Dec. 6 at IP Casino Resort Spa. RAC received the award for Renovation Over \$5 Million for the University of Mississippi Union Addition And Renovation. Receiving the award on behalf of RAC is Marketing Director Gina Creel.



Roy Anderson Corp received Gold level recognition at the ABC Mississippi Chapter Awards as well as Platinum level for the National Safety Training and Evaluation Process (STEP) at the ABC Mississippi Safety Awards luncheon held Sept. 26. Receiving the awards for RAC is Safety Coordinator Richard Rader and Jackson Office Administrator Jessica Huff.

Project Progress

CHARLESTON INTERNATIONAL AIRPORT PARKING GARAGE



MAJOR MILESTONES ACHIEVED

The Charleston International Airport will more than double its parking capacity with a new five-story, 3,000-space parking deck, set to open in fall 2020. The project includes two-helix ramps, a five-story elevator tower and elevated pedestrian bridge connecting to an existing garage. An electronic parking management system will be installed letting patrons know where spots are available. Upgrades to the existing garage include enhanced floor and ceiling finishes along with digital information boards.

Beginning in August 2019, Roy Anderson Corp has held numerous milestone lunches with raffles for the project team to show our appreciation for their hard work to achieve these milestones.



On the Move

PROFESSIONAL ACCOMPLISHMENTS

RIVERS REPRESENTS RAC AT AUTODESK U 2019



Roy Anderson Corp's BIM Department attended Autodesk University 2019 Nov. 16-19. This conference, held in Las Vegas, offers four days of learning, networking and knowledge sharing. RAC's Director of BIM/VDC Eddie Rivers was a panelist during one of the sessions presented by Satyam Verma of Pype. This session broadly covered the benefits of AI-based automation during preconstruction. Specifically, it focussed on how automating one process - scanning and parsing your spec book - can help teams bid more accurately, get to work sooner, and save time exponentially throughout the project lifecycle. One of the largest hurdles during bidding is quickly and accurately breaking down the available specs for estimating. The more in-depth a team can examine these specs, the better bid they will create. In lieu of manual searching, AI solutions can examine specs for specific requirements, including long-lead and sole-source items, and present that information to the estimating team. This approach uses the specs to create a clear scope of work, letting general contractors identify potential subcontractors even before they bid on the project.



*Pictured top, Eddie Rivers, Director of BIM/VDC , serves as a panelist for an Autodesk University session
Bottom, Cory Rouse, Evans DeHart and Eddie Rivers attending Autodesk University*

KNESAL SELECTED TO LEADERSHIP MISSISSIPPI

Geoffrey Knesal, Senior Project Manager, was selected to participate in the 2020 Class of Leadership Mississippi. Leadership Mississippi is an annual program of the Mississippi Economic Council. Participants work together in a program that combines individual study, group sessions and project experience in using leadership skills. Leadership Mississippi is the second oldest state-wide leadership program in the nation. Since its inception in 1974, Leadership Mississippi has graduated more than 1,000 alumni active in Mississippi business and politics. Mississippi's top business executives have participated in Leadership Mississippi as a way to expand their networks. Many elected leaders, including a former governor, are graduates and recognize the value of the Leadership Mississippi experience.



LEVERETTE RECOGNIZED FOR OUTSTANDING CUSTOMER



Client satisfaction is the key goal at RAC, and when a client takes the time to contact our President about an employee going above and beyond, special recognition is deserved.

Congratulations to Quality Control Manager Cornelius Leverette, left, for a job well done!



LEVEL UP

2020 RAC MANAGERS' RALLY



On Friday, January 17, Roy Anderson Corp held its Annual Managers Rally at the Hard Rock Resort in Biloxi, Miss. Management and Operations personnel listened as Dr. Samuel Jones presented a motivational and inspirational keynote. Dr. Jones used his personal story and experiences from his collegiate and professional basketball history which inspired and encouraged attendees to 'Raise the B.A.R.' and enlightened everyone on the beliefs and actions it takes to achieve desired results. Attendees also enjoyed project updates and a presentation of awards for service to employees and project excellence.





Pictured below from left to right, RAC professionals participating in teamwork activities; RAC President Mark Smith, Dr. Samuel Jones, RAC Marketing Director Gina Creel and Senior Vice President Jason Taylor; General Superintendent Aaron Hanson with Dr. Jones; service awards for milestone years of employment with RAC



2019 Project Awards and RACie Awards



In an effort to show appreciation of hard work and dedication, Roy Anderson Corp recognized the top performing projects and employees at the annual Managers' Rally.

All projects in progress during the year were scored according to a strict criteria of qualities. Those achieving the highest scores were awarded by category. The RACie awards were created to honor individual employees who show extreme diligence throughout the year. Roy Anderson Corp is proud of each and every one of our honorees and their accomplishments with RAC.

2019 PROJECT AWARD WINNERS

- Best Project Quality - WWII National Museum Hall of Democracy
- Best Project Safety - Louisiana Childrens' Museum
- Construction Innovators - Sean Rogers, Alex Shows, Aaron Hanson
- Construction Technology Award - Huntington Ingalls
East Bank Revitalization
- Excellence in Construction Award - Mississippi Aquarium

2019 RACie AWARD WINNERS

- Outstanding Leadership Award - Martin Shows
- Overachiever Award - Lindsey Baronich
- Exemplary Character Award - Patrice Ferguson
- Epitome of Teamwork Award - George Zorn
- Mentorship Award - Michelle McDaniel
- Innovation Award - Sean Rogers
- Extraordinary Diligence Award - Darren Leverette
- Customer Service Award - Cornelius Leverette

WORKFORCE *Development*



Meet The GCs

ABC Mississippi hosted the inaugural Meet The GCs event Jan. 30 at the ABC MS headquarters in Brandon, Miss. Roy Anderson Corp was featured as one of the 17 of Mississippi's leading general contractors. This exclusive, complimentary event was designed to link subcontractors, suppliers and design professionals directly with the state's leading General Contractors.



Technical Program Career Fair

Roy Anderson Corp teamed up with NAWIC at the Jackson County Schools Technology Center annual career fair Sept. 12. Set up in the construction industry room Roy Anderson Corp representatives Lindsey Baronich, April Corey, Stacy Wadsworth and Gina Creel visited with interested students and presented potential career opportunities available to them.

High School Career Seminars

The Academic Institutes at Gulfport High School hosted seminars Jan. 16 for all 11th and 12th grade students. These seminars are designed to teach students, in small group settings, about a career topic that interests them. RAC BIM Coordinator Cory Rouse and Manager of IT Operations Adam Smith presented to the Construction Technology class at GHS.





Pathways 2 Possibilities

RAC was a sponsor of the Architecture & Construction Pathway at Pathways2Possibilities (P2P) Nov. 20-21 held at the Mississippi Coast Coliseum. P2P is an interactive career expo for all 8th graders and at-risk youth, ages 16-24, in South Mississippi. Each student experiences a variety of career pathways, aligned with the U.S. and Mississippi Departments of Education. Roy Anderson Corp is proud to help develop Mississippi's workforce of tomorrow.

South Carolina Airports Coalition DBE Fly-In

Roy Anderson Corp participated in the South Carolina Airports Coalition DBE Fly-In Oct. 10 at the Exquis Event Center. RAC Plans Administrator Patrice Ferguson attended the event on behalf of RAC in effort to maximize small business participation with small business enterprises, disadvantaged business enterprises, women-owned, and veteran-owned businesses. The DBE Fly-In event is intended to give business owners the information they need to compete for airport business in the areas of construction.



Constructing Community

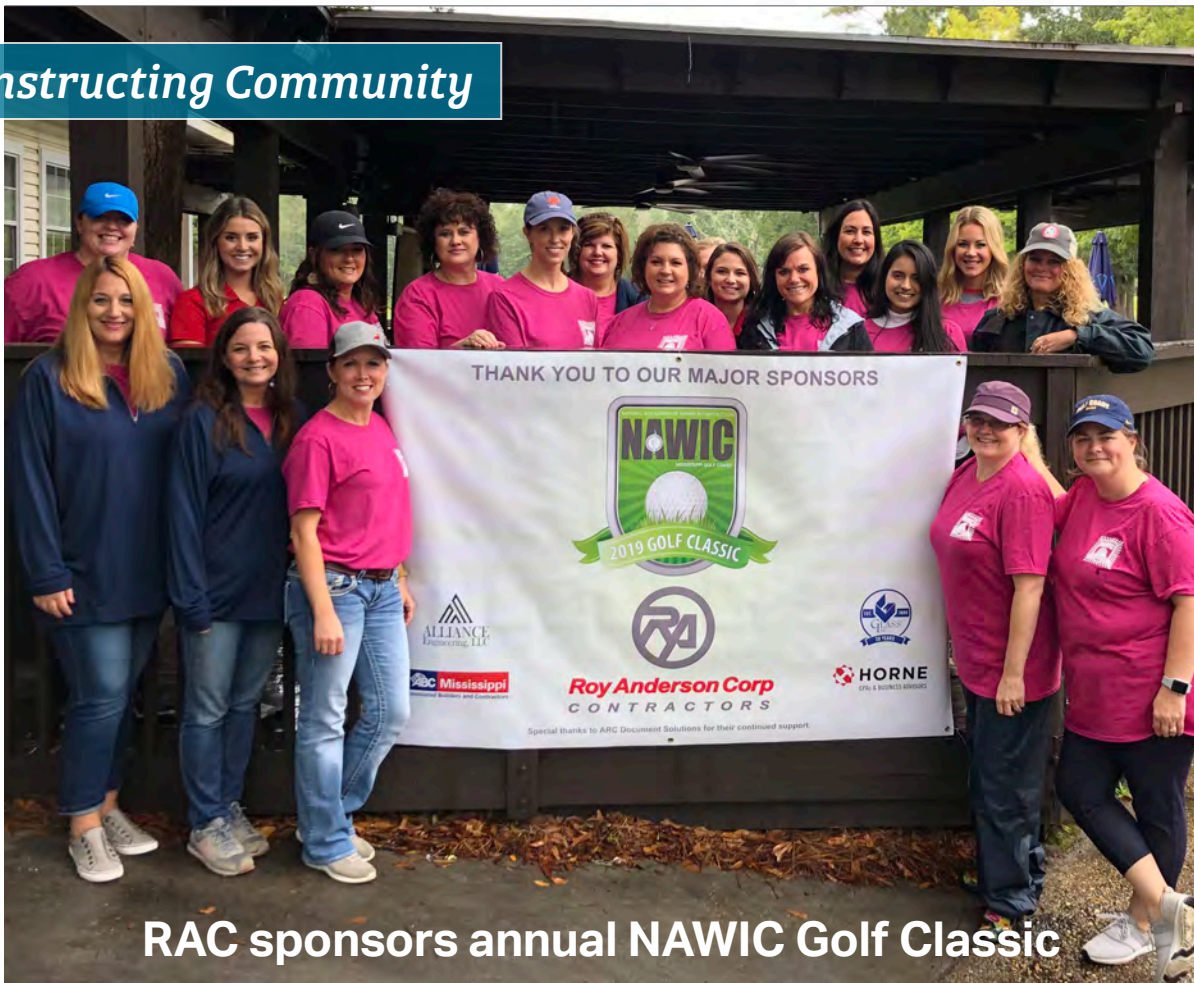

RAC sponsors annual NAWIC Golf Classic

Roy Anderson Corp was a major sponsor of the National Association of Women In Construction (NAWIC) MS Gulf Coast Chapter Annual Golf Tournament. Despite the rainy weather, the tournament was held on Oct. 18 at The Oaks Golf Club in Pass Christian, Miss. Various door prizes were given out during the day along with prizes to the first, second and third place teams and Closest to the Hole. Proceeds from the tournament fund the NAWIC scholarship fund.



RAC sponsors Pink Pearls to Save the Girls! 4th annual fashion show

On Oct. 19, Scarlet Pearl Casino Resort, in partnership with Susan G. Komen®, presented the 4th annual Pink Pearls to Save the Girls Fashion Show in the Strand Event Center of the resort. The event recognized those who have survived breast cancer, those still facing it, as well as those who have lost their lives to it.

Outfits for the fashion show were provided by Dillard's and modeled by breast cancer survivors and local celebrities. Attendees were encouraged to wear pink. In attendance from Roy Anderson Corp were Lindsey Baronich, Kelly Jones, Patricia Ferguson and Debra Tucker.



For more information on Susan G. Komen, visit ww5.komen.org.

CORPORATE SOCIAL RESPONSIBILITY



RAC promotes sustainability in Coastal Mississippi

The students from Gulfport High School built a large recycling vessel, shaped like a turtle. The project was a collaboration among the Mississippi Aquarium, Harrison County Beautification Commission, Harrison County Board of Supervisors, Roy Anderson Corp and the Career and Technical Education Program at Gulfport High School. This community project focused on sustainability and conservation. The turtle is made out of recycled materials generously donated by Roy Anderson Corp. National Oceanic and Atmospheric Administration (NOAA) provided expertise on the appropriate netting and taught the students how to sew the net.

The turtle recycling vessel was unveiled on Nov. 15 on the beach near Jones Park in Gulfport,



What is Corporate Social Responsibility (CSR)?

Corporate social responsibility (CSR) is a self-regulating business model that helps a company be socially accountable — to itself, its stakeholders, and the public. By practicing corporate social responsibility, also called corporate citizenship, companies can be conscious of the kind of impact they are having on all aspects of society including economic, social, and environmental. To engage in CSR means that, in the normal course of business, a company is operating in ways that enhance society and the environment.

Through Roy Anderson Corp's CRS program, we have also assisted with the following:

- Dixie White House Health and Rehabilitation – providing residents basic needs items
- United Way of South Mississippi – Diaper Drive
- Back Bay Mission - Food Pantry and Homeless Outreach Programs
- Feed My Sheep - Providing nourishment to the homeless, homebound and needy
- Buddy Bags – Supplies items for emergency foster care
- PROMISS – an accredited medical clinic that provides support and medical care to women who are making pregnancy related decisions.

Spotlight On ...

APRIL COREY

RAC lead estimator // running coach

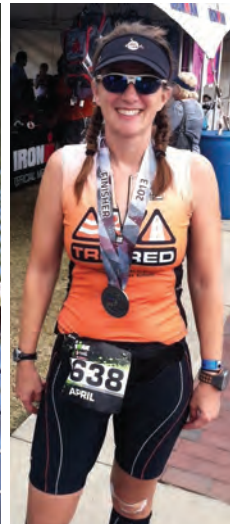

April with Nancy Crabbs; Nancy worked for Roy Anderson Corp for 13 years, and lost her battle with cancer in 2019.



In early 2011, wanting to try a new adventure, April and her sister decided to sign up for a half ironman distance triathlon as a relay. Watching the athletes compete that day fueled her fire for triathlons. Later in 2011, she trained and raced in her first sprint triathlon. From 2011 to now, April has raced in multiple sprint triathlons, half ironman distance triathlons — 1.2 mile swim, 56 mile bike and 13.1 mile run — and full ironman distance triathlons — 2.4 mile swim, 112 mile bike and 26.2 mile run. Along with triathlons, she decided to try ultramarathons — anything over the marathon distance of 26.2 miles. April raced in several ultramarathons — 31 miles, 39 miles, 50 miles and 107 miles. To date, the 107-mile

ultramarathon was her most challenging athletic adventure.

April enjoys the training and research preparation before each event. She could spend countless hours researching training methods and creates her own training plan for each race. Several years ago, with all the hours researching, a dear friend and former co-worker, Nancy Crabbs, suggested that she look into coaching triathletes. In 2014, April became a certified triathlon coach, and in 2017, she became a certified running coach. She appreciates working with athletes of all levels of experience and gets a thrill by helping them achieve their personal fitness goals.



Happenings



2020 Roy Anderson Corp New Year Party at Hard Rock Casino Resort



JACK HANNA ANIMAL VISIT

As a major sponsor of the Splash Bash, representatives from the Mississippi Aquarium and Columbus Zoo brought two Jack Hanna animals to the Corporate office where employees and guests enjoyed visiting and learning about them.

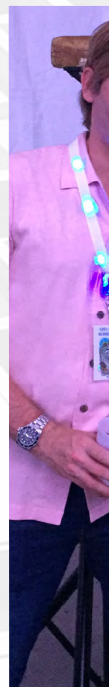

MS AQUARIUM SPLASH BASH
Splash Bash is the annual fundraiser of the Mississippi Aquarium. As a major sponsor, employees of Roy Anderson Corp supported the event and enjoyed more animal visits, food and live entertainment.

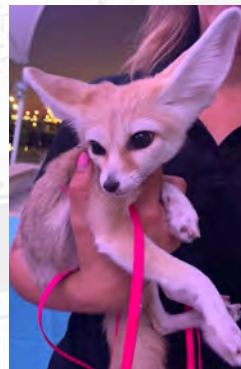

Happenings

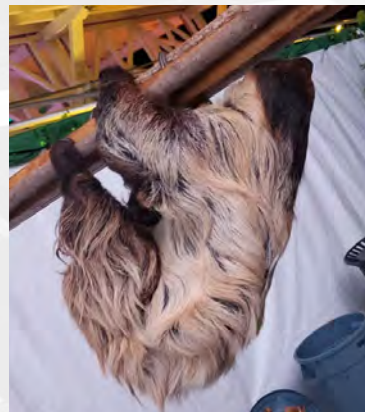
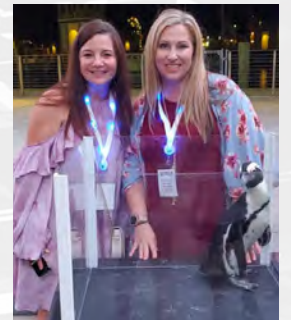

Roy Anderson Corp

C O N T R A C T O R S

P.O. BOX 2 | GULFPORT, MS 39502

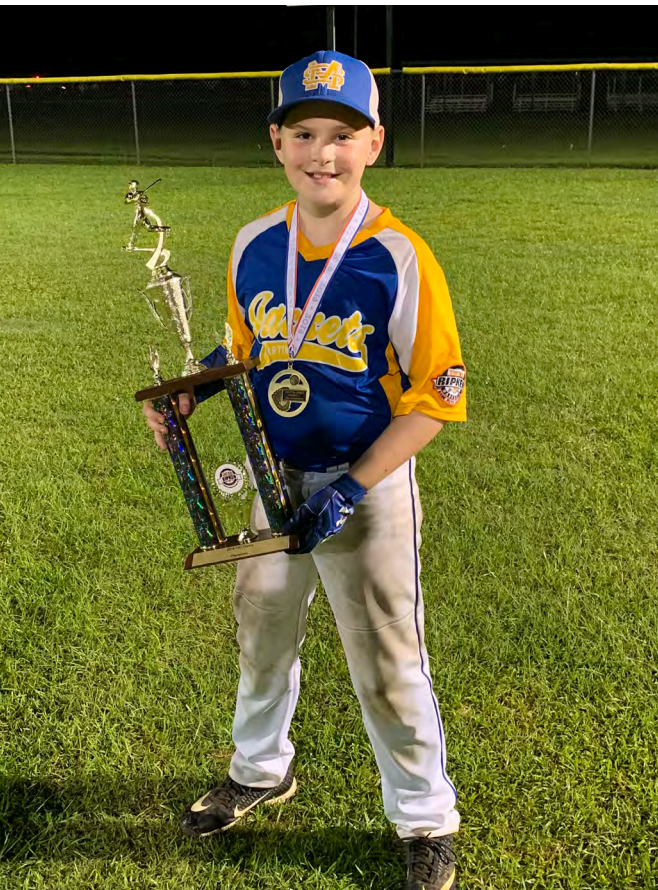
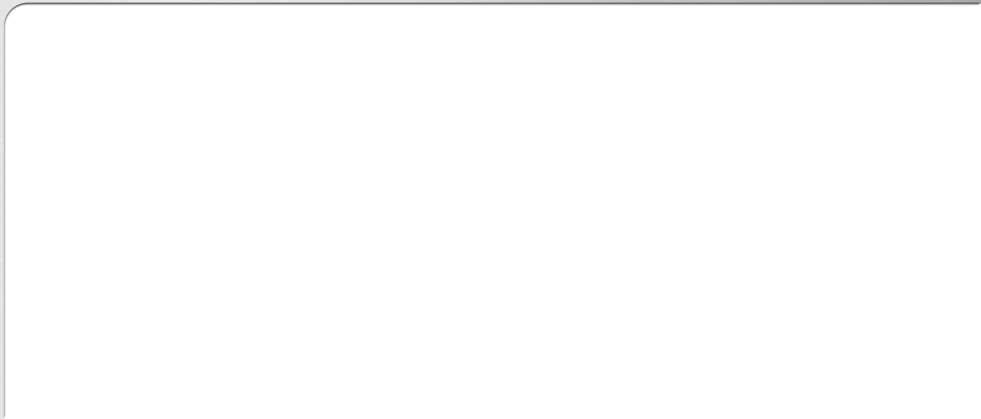

WHY DO YOU WORK SAFE?

